

# High performance cutter *Hochleistungsfräser*

with double sided insert / *mit doppelseitiger WSP*

**FMA07, FMA11, FMA12**  
**FMD02, EMP13**



your Partner  
your Value

**ZCC-CT**  
ZCC Cutting Tools Europe GmbH



# FMA07

Stable double side insert with 16 cutting edge for high productivity

Stabile doppelseitige Wendeschneidplatte mit 16 Schneidecken für hohe Wirtschaftlichkeit

Positive light cutting chip breaker for finishing to roughing in wide application field

Positive, leicht schneidende Spanbrecherform für die Schlicht- bis Schruppbearbeitung mit weitem Anwendungsspektrum

Cutter body diameter  $\varnothing 25$  to  $\varnothing 315$ , inserts ONHU06\*\* and ONHU08\*\*, Grades:

Fräserdurchmesser  $\varnothing 25$  bis  $\varnothing 315$ , WSP ONHU06\*\* und ONHU08\*\*, in den Sorten :

**YBC302**

CVD  
P15 - P35

**YBG202**

PVD  
P10 - P30

**YBM253**

CVD  
P20 - P40

**YBM351**

CVD  
P25 - P40

**YBD152**

CVD  
K05 - K25

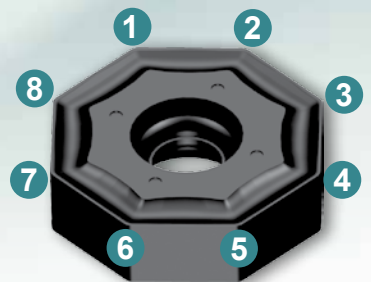

Face milling / Planfräser

**Kr:45°**



**FMA07** **P** **K**

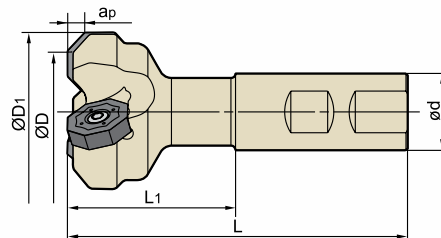

Type Typ	*	Stock Lager		Dimension Abmessung (mm)						Tooth Zähne Z	Weight Gewicht (kg)
		R	L	ØD	ØD <sub>1</sub>	ød	L	L <sub>1</sub>	a <sub>pmax</sub>		
<b>FMA07</b>	-025-XP20-ON06-02	•	○	25	37	20	95	45	4	2	0.2
	-025-XP20-ON06-02C	*	•	○	25	37	20	95	45	4	0.2
	-032-XP25-ON06-02C	*	•	○	32	44	25	111	55	4	0.4
	-040-XP25-ON06-03		○	○	40	52	25	106	50	4	0.4
<b>FMA07</b>	-032-XP25-ON08-02		•	○	32	47	25	111	55	5	0.4
	-040-XP25-ON08-03		•	○	40	55	25	111	55	5	0.5
	-040-XP25-ON08-03C	*	•	○	40	55	25	111	55	5	0.5
	-050-XP25-ON08-04		•	○	50	65	25	111	55	5	0.6

\* Internal coolant · Innenkühlung

• Ex stock / ab Lager ○ On demand / auf Anfrage

Diameter Durchmesser ØD	Insert WSP	Screw Schraube	Drehmoment Torque	Wrench Schlüssel		
Ø25 - Ø40	ONHU06**	I60M4×10	3 Nm	--	WT15IS	
Ø32 - Ø50	ONHU08**	I60M5×13	5 Nm	WT20IT	--	

### Face milling / Planfräser

Kr:45°



**FMA07** **P** **M** **K**

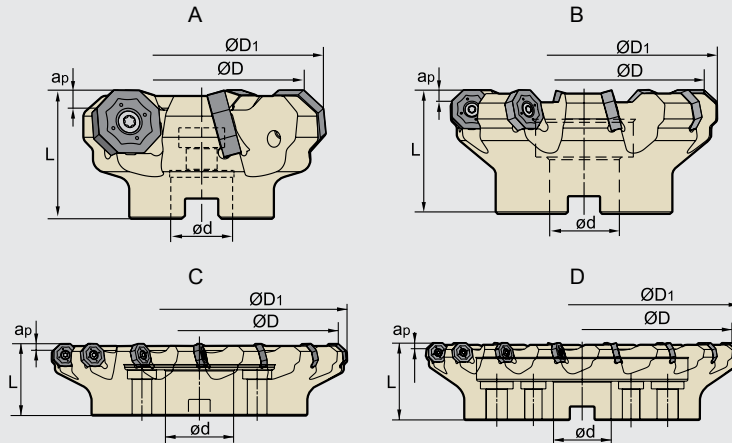

**B**

Milling Tools  
Fräser

Type Typ	*	Stock Lager		Dimension Abmessung (mm)					Tooth Zähne Z	Coupling Aufnahme	Weight Gewicht (kg)
		R	L	ØD	ØD <sub>1</sub>	ød	L	a <sub>pmax</sub>			
<b>FMA07</b> -050-A22-ON06-05		●	○	50	62	22	40	4	5	A	0.3
-050-A22-ON06-05C	*	●	○	50	62	22	40	4	5	A	0.3
-063-A22-ON06-06		●	○	63	75	22	40	4	6	A	0.5
-063-A22-ON06-06C	*	●	○	63	75	22	40	4	6	A	0.5
-080-A27-ON06-07C	*	●	○	80	92	27	50	4	7	A	1.0
-080-B27-ON06-07		●	○	80	92	27	50	4	7	B	1.0
-080-B27-ON06-07C	*	○	○	80	92	27	50	4	7	B	1.0
-100-B32-ON06-08		●	○	100	112	32	63	4	8	B	1.9
-100-B32-ON06-08C	*	○	○	100	112	32	63	4	8	B	1.9
-125-B40-ON06-09		●	○	125	137	40	63	4	9	B	3.5
-125-B40-ON06-09C	*	○	○	125	137	40	63	4	9	B	3.5
-160-C40-ON06-11		●	○	160	172	40	63	4	11	C	4.3
-200-C60-ON06-13		○	○	200	212	60	63	4	13	C	6.4
-250-C60-ON06-15		○	○	250	262	60	63	4	15	C	13.4
-315-D60-ON06-17		○	○	315	327	60	80	4	17	D	21.9
<b>FMA07</b> -063-A22-ON08-05		●	○	63	78	22	40	5	5	A	0.5
-063-A22-ON08-05C	*	●	○	63	78	22	40	5	5	A	0.5
-080-A27-ON08-06C	*	●	○	80	95	27	50	5	6	A	0.9
-080-B27-ON08-06		●	○	80	95	27	50	5	6	B	0.9
-080-B27-ON08-06C	*	○	○	80	95	27	50	5	6	B	0.9
-100-B32-ON08-07		●	○	100	115	32	63	5	7	B	1.8
-100-B32-ON08-07C	*	○	○	100	115	32	63	5	8	B	3.1
-125-B40-ON08-08		●	○	125	140	40	63	5	8	B	3.1
-125-B40-ON08-08C	*	●	○	125	140	40	63	5	8	B	3.1
-160-C40-ON08-10		●	○	160	175	40	63	5	10	C	4.1
-200-C60-ON08-12		●	○	200	215	60	63	5	12	C	6.1
-250-C60-ON08-14		●	○	250	265	60	63	5	14	C	12.0
-315-D60-ON08-16		○	○	315	330	60	80	5	16	D	21.0

\* Internal coolant · Innenkühlung

● Ex stock / ab Lager ○ On demand / auf Anfrage

Diameter Durchmesser ØD	Insert WSP	Screw Schraube	Drehmoment Torque	Wrench Schlüssel		
Ø50 - Ø315	ONHU06**	I60M4×10	3 Nm	--	WT15IS	
Ø63 - Ø315	ONHU08**	I60M5×13	5 Nm	WT20IT	--	

We recommend to use torque wrenches · Wir empfehlen den Einsatz von Drehmomentschlüsseln

# Milling - Fräsen

## Indexable Milling Tools - Wendepplattenfräser

### Applicable inserts Wendeschneidplatten

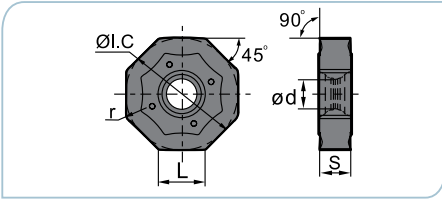

- Ideal Machining Condition / Gute Bearbeitungsbedingungen
- Normal Machining Condition / Normale Bearbeitungsbedingungen
- Unfavorable Machining Condition / Ungünstige Bearbeitungsbedingungen

Workpiece Material / Werkstoffe	P	M	K	N	S	YBC301	YBC302	YBC401	YBM251	YBM253	YBM351	YBD152	YBD252	YBG102	YBG202	YBG205	YBG302	YBG152	YBG252	YNG151	YNG151C	YC30S	YD101	YD201
P Steel / Stahl	●	●	●	●	●	●	●	●	●	●	●	●	●	●	●	●	●	●	●	●	●	●	●	●
M Stainless Steel / Rostfreier Stahl	●	●	●	●	●	●	●	●	●	●	●	●	●	●	●	●	●	●	●	●	●	●	●	●
K Cast iron / Gusseisen			●																					
N Non-ferrite material / Ne Metalle																								
S Heat-resistant steel / Warmfester Stahl																								

Insert WSP	Type Typ	Dimension Abmessung (mm)					CVD Coating CVD Beschicht.					PVD Coating PVD Beschicht.					Cermet Cermet	Carbide uncoat. unb. Hartmetall								
		L	ØI.C	S	Ød	r	YBC301	YBC302	YBC401	YBM251	YBM253	YBM351	YBD152	YBD252	YBG102	YBG202		YBG205	YBG302	YBG152	YBG252	YNG151	YNG151C	YC30S	YD101	YD201
	ONHU060408-PF	6.58	15.875	4.76	4.4	0.83	●								●											
	ONHU08T508-PF	8.39	20.2	5.79	5.3	0.83	●						○		●											
	ONHU060408-PM	6.58	15.875	4.76	4.4	0.83	●																			
	ONHU08T508-PM	8.39	20.2	5.79	5.3	0.83	●																			

● Ex Stock / ab Lager ○ On demand / auf Anfrage

### Cutting Data / Schnittdaten

Workpiece material / Werkstück Material	Hardness HB / Härte	Grade / Sorte	Cutting data · Schnittdaten				
			V <sub>c</sub> (m/min)	f <sub>z</sub> (mm/z)	a <sub>p</sub> (mm)		
					ONHU06**-PM	ONHU08**-PM	
P Low-carbon steel / Soft steel / Niedriglegierter Kohlenstoffstahl Baustahl	≤180	YBC302	270 (220-350)	0.2 (0.1-0.4)	4	5	
		YBG202					
		YBM253					
	180-280	YBC302	240 (200-320)	0.2 (0.1-0.4)	4	5	
		YBG202	240 (180-350)	0.2 (0.1-0.4)	4	5	
		YBM253	260 (200-320)	0.2 (0.1-0.4)	4	5	
		YBM351	200 (180-280)	0.2 (0.1-0.4)	4	5	
280-350	YBC302	240 (180-300)	0.2 (0.1-0.4)	4	5		
	YBM253	240 (180-300)	0.2 (0.1-0.4)	4	5		
	YBM351	180 (150-250)	0.2 (0.1-0.4)	4	5		
K Cast iron / Gusseisen	180-250	YBD152	270 (150-300)	0.4 (0.1-0.5)	4	5	

### For example

#### Beispiel

Milling Tools / Fräser: FMA07-100-B32-ON08-07

Insert / WSP: ONHU08T508-PM YBD152

Parts / Teile: Case of gear pump / Pumpengehäuse

Workpiece material: GG40 Gray cast iron / Werkstückstoff: Grauguss

Cooling system / Kühlsystem: dry cutting / trocken

Machine / Maschine: NC floor Type / CNC Maschine

Cutting data / Schnittdaten: V<sub>c</sub>=267m/min f<sub>z</sub>=0.42mm/z  
a<sub>p</sub>=1.5mm a<sub>e</sub>=80mm

Direction / Richtung: Climb milling / Gleichlaufräsen

Processing site: End face / Bearbeitungsebene: Planfläche



### Wear comparison of insert / Verschleißvergleich der WSP

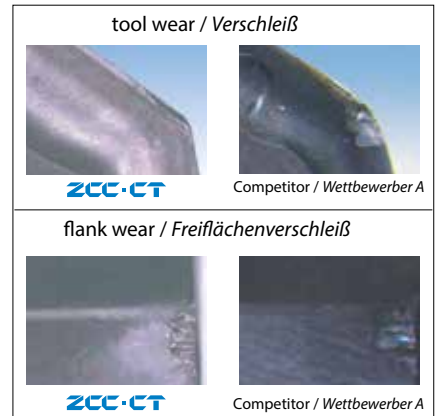

# FMA 11 *Kr:45°*

**New generation of face milling with double sided insert**  
**Neue Planfräsergeneration mit doppelseitiger WSP**

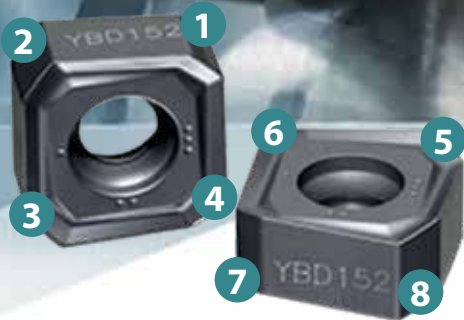

Double sided inserts  
 Doppelseitige WSP

8 cutting edge

8 Schneidkanten für wirtschaftliche Auslastung der WSP.

Inserts with big rake angle, reducing power consumption.

Großer Spanwinkel für weichen Schnitt.

Milling cutter with thicker inserts for high stability and big cutting depth.

Doppelseitige, extra dicke Wendeschneidplatte für große Spantiefen bei hoher Bruchsicherheit.

Insert Grade:  
 WSP Sorten:

**YBC302**

CVD  
 P15 - P35

**YBM253**

CVD  
 P20 - P40

**YBD152**

CVD  
 K05 - K25

$a_p$  max:



Inserts with wiper cutting edge for good surface quality.

Wiper Geometrie für beste Oberflächengüte.

## Comparison of wear

### Vergleich

Workpiece Material: GG30 Grey cast iron  
 Werkstück Material: Grauguss

Machining: Face milling  
 Bearbeitung: Planfräsen

Tool / Werkzeug: FMA11-125-B40-SN12-08

Inserts / WSP: SNEG1205ANR-GM/YBD152

Cutting data:  $V_c=300\text{m/min}$   $f_z=0.3\text{ mm/z}$   
 Schnittdaten:  $a_p=3\text{mm}$   $a_e=80\text{mm}$

	Major cutting edge Hauptschneidkante	Minor Cutting edge Nebenschneidkante	Wiper
FMA11 After 3 Workpieces of machining Nach 3 bearbeiteten Werkstücken			
Competitor / Wettbewerb After 2 Workpieces of machining Nach 3 Bearbeiteten Werkstücken			

# Milling · Fräsen

Indexable Milling Tools · Wendepplattenfräser

## Face Milling Tools · Planfräser

Kr:45°



**FMA11 P K**

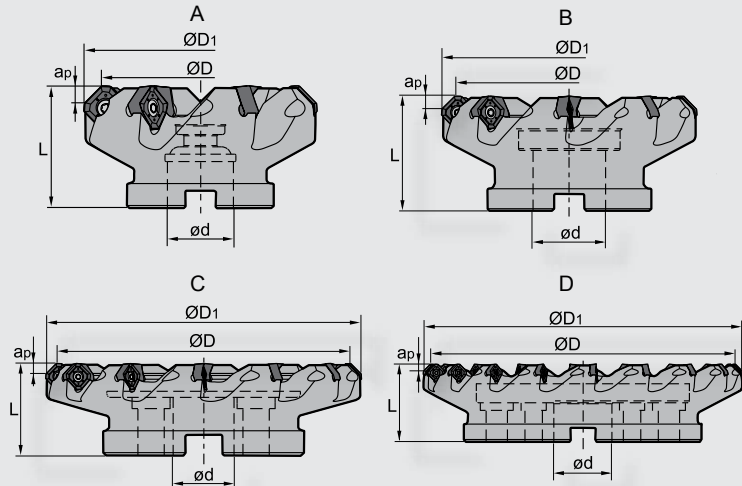





### Specification of tools · Werkzeug Beschreibung

Type Typ	*	Stock Lager		Dimension (mm) Abmessung					No. of teeth Zähne	Coupling Aufnahme	Weight Gewicht (kg)	
		R	L	ØD	ØD <sub>1</sub>	Ød	L	a <sub>pmax</sub>				
<b>FMA11</b>	-063-A22-SN12-05	*	●		63	74.47	22	40	5.5	5	A	0.55
	-080-A27-SN12-06	*	●		80	91.47	27	50	5.5	6	A	1.14
	-100-B32-SN12-07		●		100	111.47	32	50	5.5	7	B	1.42
	-100-B32-SN12-07C	*	○		100	111.47	32	50	5.5	7	B	1.42
	-125-B40-SN12-08		●		125	136.47	40	63	5.5	8	B	2.86
	-125-B40-SN12-08C	*	○		125	136.47	40	63	5.5	8	B	2.86
	-160-C40-SN12-10		●		160	171.47	40	63	5.5	10	C	4.06
<b>FMA11</b>	-063-A22-SN15-05	*	●		63	77.4	22	40	7.0	5	A	0.56
	-080-A27-SN15-06	*	●		80	94.4	27	50	7.0	6	A	1.06
	-100-B32-SN15-07		●		100	114.4	32	50	7.0	7	B	1.47
	-100-B32-SN15-07C	*	○		100	114.4	32	50	7.0	7	B	1.47
	-125-B40-SN15-08		●		125	139.4	40	63	7.0	8	B	2.70
	-125-B40-SN15-08C	*	○		125	139.4	40	63	7.0	8	B	2.70
	-160-C40-SN15-10		●		160	174.4	40	63	7.0	10	C	3.92
	-200-C60-SN15-12		●		200	214.4	60	63	7.0	12	C	5.46
	-250-C60-SN15-14		●		250	264.4	60	63	7.0	14	C	11.26
	-315-D60-SN15-18		○		315	329.4	60	80	7.0	18	D	20.00
<b>FMA11</b>	-125-B40-SN19-07		●		125	142.63	40	63	9.0	7	B	3.00
	-125-B40-SN19-07C	*	●		125	142.63	40	63	9.0	7	B	3.00
	-160-C40-SN19-09		●		160	167.63	40	63	9.0	9	C	4.25
	-200-C60-SN19-11		●		200	217.63	60	63	9.0	11	C	6.18
	-250-C60-SN19-13		●		250	267.63	60	63	9.0	13	C	11.55
	-315-D60-SN19-16		○		315	332.63	60	80	9.0	16	D	20.90

\* Internal coolant · Innenkühlung

● Ex stock / ab Lager ○ On demand / auf Anfrage

### Spare Parts · Ersatzteile

Diameter Durchmesser Ø D	Insert WSP	Screw Schraube	Drehmoment Torque	Wrench Schlüssel	
					
SN12 Ø63 - Ø200	SNEG1205ANR-GR	I60M3.5x10	3 Nm		WT15IS
SN15 Ø63 - Ø315	SNEG1506ANR-GR	I60M5x13	5 Nm	WT20IT	
SN19 Ø125 - Ø315	SNEG1907ANR-GR	I43M6x16	6 Nm	WT25IT	



We recommend to use torque wrenches · Wir empfehlen den Einsatz von Drehmomentschlüsseln

### Applicable inserts · Wendeschneidplatten

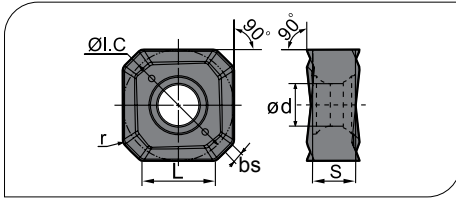

- Ideal Machining Condition / Gute Bearbeitungsbedingungen
- Normal Machining Condition / Normale Bearbeitungsbedingungen
- Unfavorable Machining Condition / Ungünstige Bearbeitungsbedingungen

Workpiece Material / Werkstoffe	P	M	K	N	S
Steel / Stahl	●	●	●	●	●
Stainless Steel / Rostfreier Stahl	●	●	●	●	●
Cast iron / Gusseisen	●	●	●	●	●
Non-ferrous material / Ne Metalle	●	●	●	●	●
Heat-resistant steel / Warmfester Stahl	●	●	●	●	●

Insert shape / Plattenform	Type / Typ	Dimension (mm) / Abmessung						CVD Coating / CVD Beschicht.					PVD Coating / PVD Beschicht.			Cermet / Cermet	Carbide uncoat. / unbe. Hartmetall										
		L	I.C	S	bs	Ø d	r	YBC301	YBC302	YBC401	YBM251	YBM253	YBM351	YBD152	YBD252		YBG102	YBG202	YBG205	YBG302	YBG152	YBG252	YNG151	YNG151C	YC30S	YD101	YD201
	SNEG1205ANR-GM	7.6	12.0	4.76	1.05	4.6	0.8	●				●	●														
	SNEG1506ANR-GM	9.4	15.0	5.54	1.30	5.5	0.9	●				●	●														
	SNEG1204ANR-GR	7.6	12.0	4.76	1.05	4.6	0.8	●				●	●														
	SNEG1506ANR-GR	9.4	15.0	5.54	1.30	5.5	0.9	●				●	●														
	SNEG1907ANR-GR	12.1	19.0	7.0	1.67	7.2	1.0	●				●	●														

### Recommended cutting data · Empfohlene Schnittdaten

Workpiece material / Werkstückstoff	Hardness HB / Härte	Grade / Sorte	Cutting data / Schnittdaten		
			V (m/min)	f (mm/z)	a <sub>pmax</sub>
<b>P</b> Low-carbon steel / Soft steel / Niederlegierter Kohlenstoffstahl / Baustahl	≤180	YBM253	270 (220-350)	0.2 (0.1-0.4)	5.5-9.0
		YBC302	270 (220-350)	0.2 (0.1-0.4)	5.5-9.0
	180-280	YBM253	260 (200-320)	0.2 (0.1-0.4)	5.5-9.0
		YBC302	260 (200-320)	0.2 (0.1-0.4)	5.5-9.0
	280-350	YBM253	240 (180-300)	0.2 (0.1-0.4)	5.5-9.0
		YBC302	240 (180-300)	0.2 (0.1-0.4)	5.5-9.0
<b>K</b> Cast iron / Gusseisen	180-250	YBD152	270 (150-300)	0.4 (0.1-0.5)	5.5-9.0

### Mounting double side inserts:

Montage von doppelseitigen Wendeschneidplatten bei Fräsern:



Please make sure that the faces with same marks are in the same direction.

Bitte stellen Sie sicher, dass die Platten mit gleicher Markierung in dieselbe Richtung angebracht werden.

# FMA12 *Kr:45°*

High Performance Face Mill with 16 edges for outstanding economy

Hochleistungs-Planfräser mit 16 Schneidkanten für hervorragende Wirtschaftlichkeit

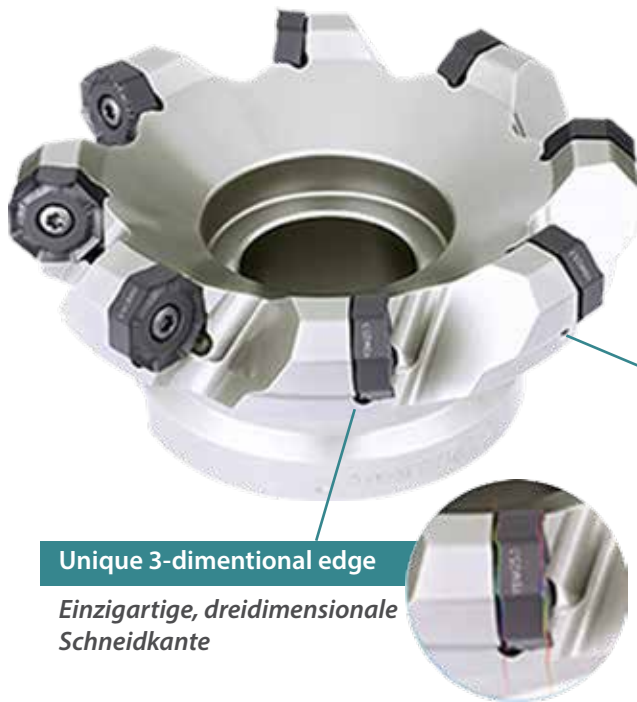

Unique 3-dimensional edge

Einzigartige, dreidimensionale Schneidkante



$a_p$  max:

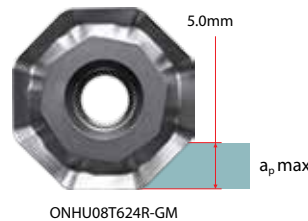

ONHU08T624R-GM

Economic / Wirtschaftlichkeit:



8x2=16 edges

Double negative rake angle, in combination with helical insert structure, achieves double positive axial angle, which will help reduce cutting resistance and improve chip evacuation.

Doppelt negative Spanwinkel in Kombination mit einer spiralförmigen Struktur führen zu doppelt positiven Achswinkeln, die zu einer Reduzierung des Schneidwiderstandes führen und die Spanabfuhr verbessern.

Smooth cut due to positive and sharp cutting edge.

Weicher Schnitt durch positive und scharfe Schneidkantenausführung.

## Comparing of wear

Vergleich

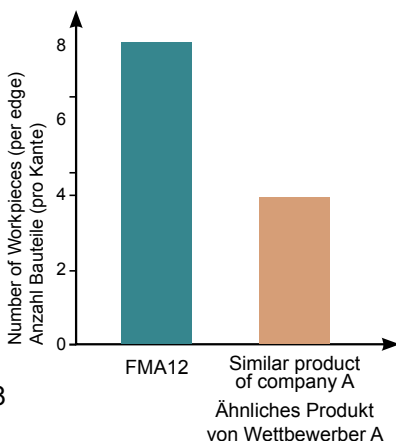

## Example

Beispiel



Workpiece: Cylinder  
Werkstück: Zylinder

Workpiece Material: HB250 Gray cast iron  
Werkstück Material: Grauguss

Machining: Face milling  
Bearbeitung: Planfräsen

Tool / Werkzeug: FMA12-160-C40-ON08-10

Inserts / WSP: ONHU08T624R-GM/YBD152

Cutting data:  $V_c=150\text{m/min}$   $f_z=0.25\text{ mm/z}$   
Schnittdaten:  $a_p=3\text{mm}$   $a_e=160\text{mm}$

Cooling: External  
Kühlung: Außen

Insert Grade:  
WSP Sorten:

**YBM253**

CVD  
P20 - P40  
M10 - M30

**YBG205**

PVD  
P10 - P30  
M10 - M30

**YBD152**

CVD  
K05 - K25



### Face Milling Tools · Planfräser

Kr:45°



**FMA12 P K**

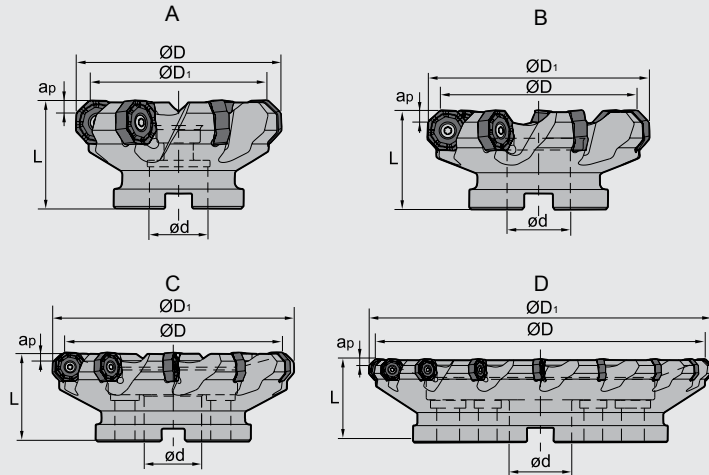





#### Specification of tools · Werkzeug Beschreibung

Type Typ	*	Stock Lager		Dimension (mm) Abmessung					No. of teeth Zähne	Coupling Aufnahme	Weight Gewicht (kg)
		R	L	ØD	ØD <sub>1</sub>	Ød	L	a <sub>pmax</sub>			
<b>FMA12</b>											
-063-A22-ON08-05	*	●		63	78	22	50	5.0	5	A	0,6
-080-A27-ON08-06	*	●		80	95	27	50	5.0	6	A	0.97
-100-B32-ON08-07		●		100	115	32	50	5.0	7	B	1.28
-100-B32-ON08-07C	*	●		100	115	32	50	5.0	7	B	1.28
-125-B40-ON08-08		●		125	140	40	63	5.0	8	B	2.59
-125-B40-ON08-08C	*	●		125	140	40	63	5.0	8	B	2.59
-160-C40-ON08-10		●		160	175	40	63	5.0	10	C	4.10
-200-C60-ON08-12		○		200	215	60	63	5.0	12	C	5.68
-250-C60-ON08-14		○		250	265	60	63	5.0	14	C	11.90
-315-D60-ON08-18		○		315	330	60	80	5.0	18	D	20.41

\* Internal coolant · Innenkühlung

● Ex stock / ab Lager ○ On demand / auf Anfrage

#### Spare Parts · Ersatzteile

Diameter Durchmesser Ø D	Insert WSP	Screw Schraube	Drehmoment Torque	Wrench Schlüssel	
Ø80-Ø315	 ONHU08T624R-GM	 I60M5X13	5 Nm	 WT20IT	

We recommend to use torque wrenches · Wir empfehlen den Einsatz von Drehmomentschlüsseln

**B**

Milling Tools  
Fräser



# FMD02

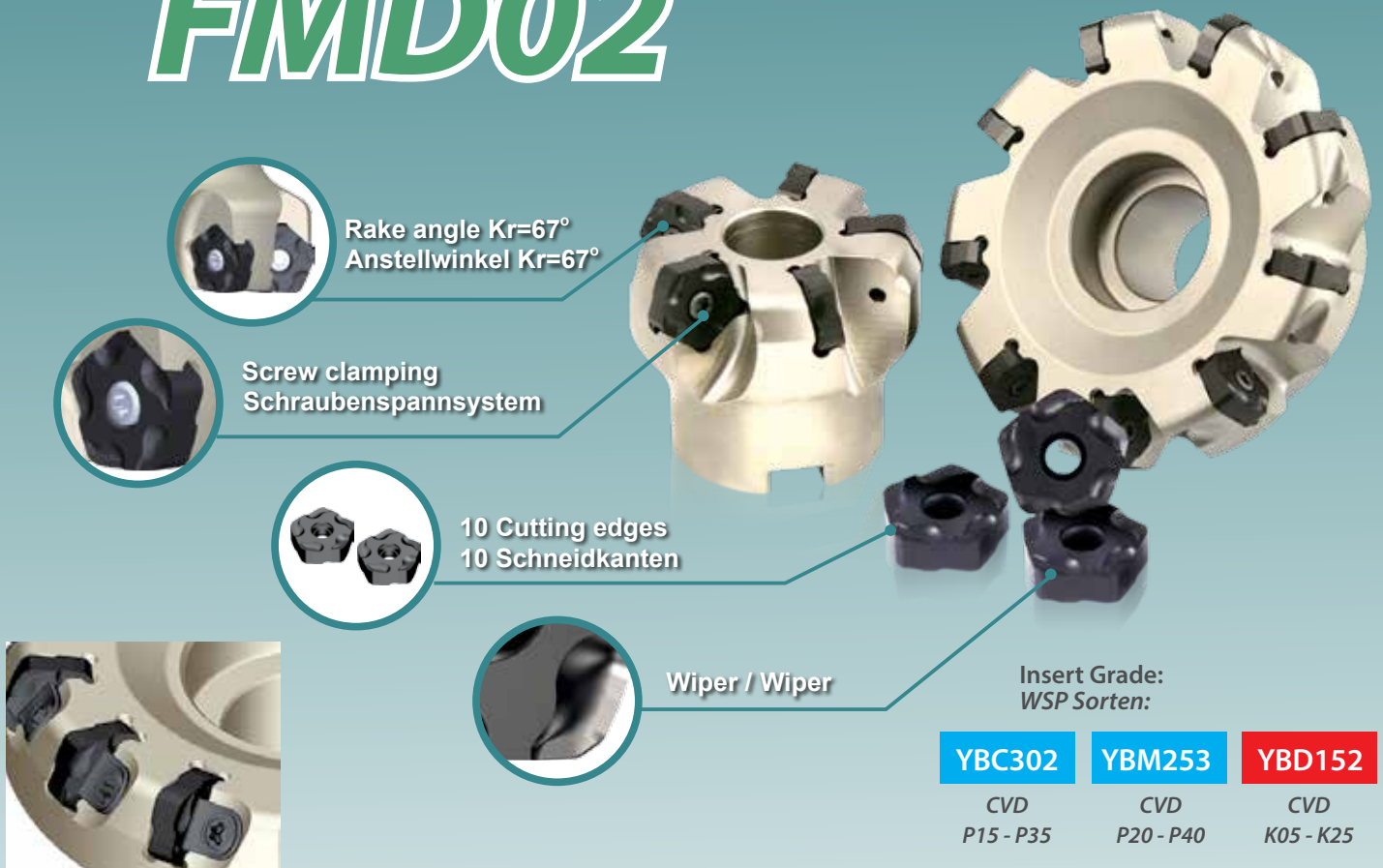

Clamping by wedge for highest accuracy and reliability.

*Klemmkeilspannung für höchste Stabilität und Wiederholgenauigkeit.*

Machining of cast iron  
Gussbearbeitung  
 $a_{p\max}=5\text{ mm}$

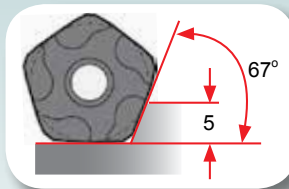

Steel, Alloy steel  
Stahl, Legierter Stahl  
 $a_{p\max}=7.5\text{ mm}$

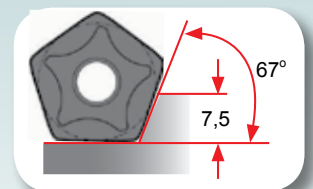

Holder/ Halter	FMD02-100-B32-PN11-10 <b>ZCC-CT</b>	Competitor A / Wettbewerber A
Insert/ WSP	PNEG110512R-CR/YBD152	
Cutting data Schnittdaten	D=100 mm $a_p=3\sim5\text{ mm}$ Vc=243 m/min $f_z=0.15\text{ mm/Z}$ 145~155 pcs / Stück	D=100 mm $a_p=3\sim5\text{ mm}$ Vc=243 m/min $f_z=0.12\text{ mm/Z}$ 120~133 pcs / Stück

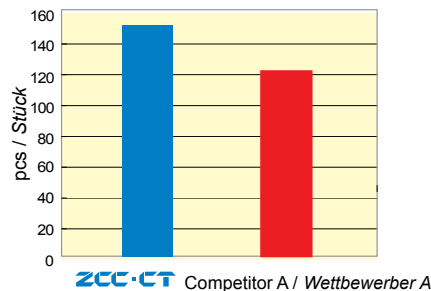

Comparison of wear / Verschleißvergleich

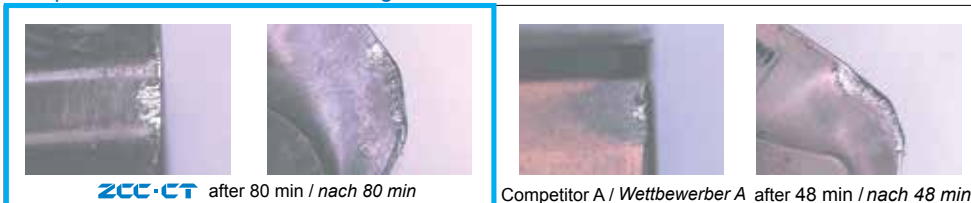



### Face Milling Tools · Planfräser

#### FMD02

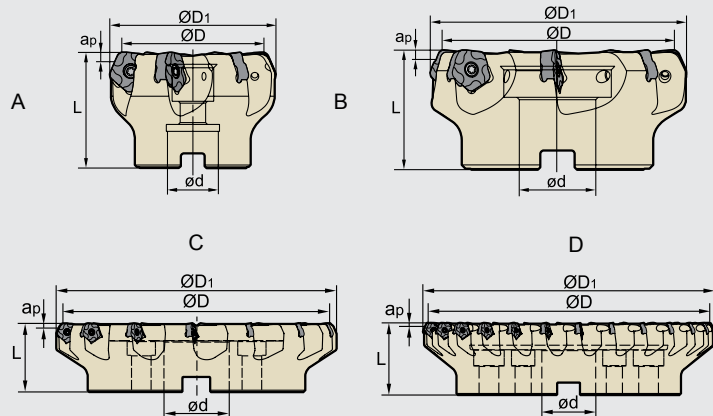

#### ■ Specification of tools · Werkzeug Beschreibung

Type Typ	*	Stock Lager		Dimension (mm) Abmessung					No. of teeth Zähne	Coupling Aufnahme	Weight Gewicht (kg)
		R	L	ØD	ØD <sub>1</sub>	ød	L	a <sub>pmax</sub>			
FMD02	-050-A22-PN11-04	●	○	50	60.1	22	50	5	4	A	0.6
	-050-A22-PN11-04C	*	○	50	60.1	22	50	5	4	A	0.6
	-063-A22-PN11-05	●	○	63	73.1	22	50	5	5	A	0.8
	-063-A22-PN11-05C	*	○	63	73.1	22	50	5	5	A	0.8
	-080-A27-PN11-06	●	○	80	90.1	27	50	5	6	A	1.1
	-080-A27-PN11-06C	*	○	80	90.1	27	50	5	6	A	1.1
	-100-B32-PN11-07	●	○	100	110.1	32	50	5	7	B	1.8
	-100-B32-PN11-07C	*	○	100	110.1	32	50	5	7	B	1.8
	-125-B40-PN11-08	●	○	125	135.1	40	63	5	8	B	2.9
	-125-B40-PN11-08C	*	○	125	135.1	40	63	5	8	B	2.9
	-160-B40-PN11-10	○	○	160	170.1	40	63	5	10	B	5.6
	-200-C60-PN11-12	○	○	200	210.1	60	63	5	12	C	7.9
-200-C60-PN11-24	●	○	200	210.1	60	63	5	24	C	8.6	
-250-C60-PN11-14	○	○	250	260.1	60	63	5	14	C	13.4	
-250-C60-PN11-30	●	○	250	260.1	60	63	5	30	C	13.5	
FMD02	-050-A22-PN11-05	●	○	50	60.1	22	50	5	5	A	0.6
	-050-A22-PN11-05C	*	●	50	60.1	22	50	5	5	A	0.6
	-063-A22-PN11-05	●	○	63	71.3	22	50	5	5	A	0.7
	-063-A22-PN11-06	●	○	63	73.1	22	50	5	6	A	0.9
	-063-A22-PN11-06C	*	●	63	73.1	22	50	5	6	A	0.9
	-080-A27-PN11-08	●	○	80	90.1	27	50	5	8	A	1.2
	-080-A27-PN11-08C	*	●	80	90.1	27	50	5	8	A	1.2
	-100-B32-PN11-10	●	○	100	110.1	32	50	5	10	B	1.9
	-100-B32-PN11-10C	*	○	100	110.1	32	50	5	10	B	1.9
	-125-B40-PN11-12	●	○	125	135.1	40	63	5	12	B	3.2
	-125-B40-PN11-12C	*	○	125	135.1	40	63	5	12	B	3.2
	-160-B40-PN11-14	●	○	160	170.1	40	63	5	14	B	6.4
	-200-C60-PN11-16	●	○	200	210.1	60	63	5	16	C	8.5
	-200-C60-PN11-20	○	○	200	210.1	60	63	5	20	C	8.5
-250-C60-PN11-18	●	○	250	260.1	60	63	5	18	C	18.0	
-315-D60-PN11-26	○	○	315	325.1	60	80	5	26	D	24.5	

\* Internal coolant · Innenkühlung

● Ex stock / ab Lager ○ On demand / auf Anfrage

#### ■ Spare Parts · Ersatzteile

Diameter Durchmesser Ø D	Screw Schraube	Drehmoment Torque	Wrench Schlüssel	
Ø50 - Ø315	I60M4×10	3 Nm	WT15IS	

We recommend to use torque wrenches · Wir empfehlen den Einsatz von Drehmomentschlüsseln



### Face Milling Tools · Planfräser

#### FMD02

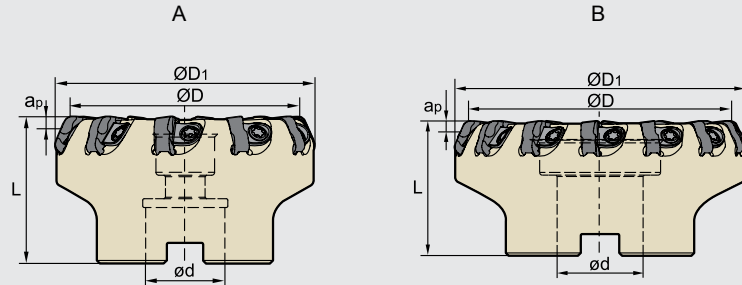





#### Specification of tools · Werkzeug Beschreibung

Type Typ	* 	Stock Lager		Dimension (mm) Abmessung					No. of teeth Zähne	Coupling Aufnahme	Weight Gewicht (kg)
		R	L	$\Delta D$	$\Delta D_1$	$\Delta d$	L	$a_{pmax}$			
<b>FMD02</b> -080-A27-PN11-10		●	○	80	90.1	27	50	5	10	A	1.3
-080-A27-PN11-10C	*	○	○	80	90.1	27	50	5	10	A	1.3
-100-B32-PN11-14		●	○	100	110.1	32	50	5	14	B	1.6
-100-B32-PN11-14C	*	○	○	100	110.1	32	50	5	14	B	1.6
-125-B40-PN11-18		●	○	125	135.1	40	63	5	18	B	3.2
-125-B40-PN11-18C	*	○	○	125	135.1	40	63	5	18	B	3.2
-160-B40-PN11-22		●	○	160	170.1	40	63	5	22	B	5.8
-200-C60-PN11-28		●	○	200	210.1	60	63	5	28	C	8.5

\* Internal coolant · Innenkühlung

● Ex stock / ab Lager ○ On demand / auf Anfrage

#### Spare Parts · Ersatzteile

$\Delta D$	Wedge / Keil	Screw / Schraube	Drehmoment Torque	Wrench / Schlüssel	
$\Delta 80 - \Delta 160$	 W18N	 DM6×20A	5 Nm	 WT15IT	

We recommend to use torque wrenches · Wir empfehlen den Einsatz von Drehmomentschlüsseln

# Milling - Fräsen

## Indexable Milling Tools - Wendeschneidfräser

### Applicable inserts Wendeschneidplatten

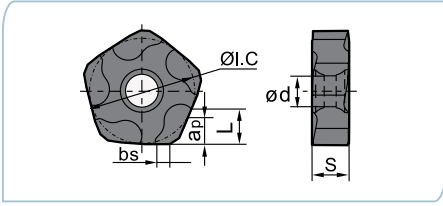

- Ideal Machining Condition  
Gute Bearbeitungsbedingungen
- ⊗ Normal Machining Condition  
Normale Bearbeitungsbedingungen
- ⊗ Unfavorable Machining Condition  
Ungünstige Bearbeitungsbedingungen

Workpiece Material Werkstoff	P Steel Stahl	M Stainless Steel Rostfreier Stahl	K Cast iron Gusseisen	N Non-ferrous material Nichte Metalle	S Heat-resistant steel Wärmefester Stahl
P	●●●●●●●●●●	●●●●●●●●●●	●●●●●●●●●●	●●●●●●●●●●	●●●●●●●●●●
M	●●●●●●●●●●	●●●●●●●●●●	●●●●●●●●●●	●●●●●●●●●●	●●●●●●●●●●
K	●●●●●●●●●●	●●●●●●●●●●	●●●●●●●●●●	●●●●●●●●●●	●●●●●●●●●●
N	●●●●●●●●●●	●●●●●●●●●●	●●●●●●●●●●	●●●●●●●●●●	●●●●●●●●●●
S	●●●●●●●●●●	●●●●●●●●●●	●●●●●●●●●●	●●●●●●●●●●	●●●●●●●●●●

Insert WSP	Type Typ	Dimension Abmessung (mm)						CVD Coating CVD Beschicht.					PVD Coating PVD Beschicht.					Cermet Cermet	Carbide uncoat. unb. Hartmetall								
		L	ØI.C	S	ød	bs	a <sub>p,max</sub>	YBC301	YBC302	YBC401	YBM251	YBM253	YBM351	YBD152	YBD252	YBG102	YBG202		YBG205	YBG302	YBG152	YBG252	YNG151	YNG151C	YC30S	YD101	YD201
	PNEG110512R-CF	5.4	15.875	5.56	4.64	1.6	5							●													
	PNEG110512L-CF	5.4	15.875	5.56	4.64	1.6	5							○													
	PNEG110512R-CM	5.4	15.875	5.56	4.64	1.6	5							●													
	PNEG110512L-CM	5.4	15.875	5.56	4.64	1.6	5							○													
	PNEG110512R-CR	5.4	15.875	5.56	4.64	1.6	5							●	●												
	PNEG110512L-CR	5.4	15.875	5.56	4.64	1.6	5							○													

### Applicable inserts Wendeschneidplatten

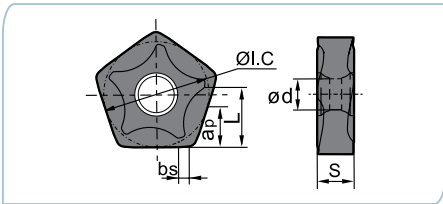

- Ideal Machining Condition  
Gute Bearbeitungsbedingungen
- ⊗ Normal Machining Condition  
Normale Bearbeitungsbedingungen
- ⊗ Unfavorable Machining Condition  
Ungünstige Bearbeitungsbedingungen

Workpiece Material Werkstoff	P Steel Stahl	M Stainless Steel Rostfreier Stahl	K Cast iron Gusseisen	N Non-ferrous material Nichte Metalle	S Heat-resistant steel Wärmefester Stahl
P	●●●●●●●●●●	●●●●●●●●●●	●●●●●●●●●●	●●●●●●●●●●	●●●●●●●●●●
M	●●●●●●●●●●	●●●●●●●●●●	●●●●●●●●●●	●●●●●●●●●●	●●●●●●●●●●
K	●●●●●●●●●●	●●●●●●●●●●	●●●●●●●●●●	●●●●●●●●●●	●●●●●●●●●●
N	●●●●●●●●●●	●●●●●●●●●●	●●●●●●●●●●	●●●●●●●●●●	●●●●●●●●●●
S	●●●●●●●●●●	●●●●●●●●●●	●●●●●●●●●●	●●●●●●●●●●	●●●●●●●●●●

Insert WSP	Type Typ	Dimension Abmessung (mm)						CVD Coating CVD Beschicht.					PVD Coating PVD Beschicht.					Cermet Cermet	Carbide uncoat. unb. Hartmetall								
		L	ØI.C	S	ød	bs	a <sub>p,max</sub>	YBC301	YBC302	YBC401	YBM251	YBM253	YBM351	YBD152	YBD252	YBG102	YBG202		YBG205	YBG302	YBG152	YBG252	YNG151	YNG151C	YC30S	YD101	YD201
	PNEG110512R-PF	7.5	15.875	5.56	4.64	1.6	7.5	○			○																
	PNEG110512L-PF	7.5	15.875	5.56	4.64	1.6	7.5	○			○																
	PNEG110512R-PM	7.5	15.875	5.56	4.64	1.6	7.5	●			●																
	PNEG110512L-PM	7.5	15.875	5.56	4.64	1.6	7.5	○			○																
	PNEG110512R-PR	7.5	15.875	5.56	4.64	1.6	7.5	○			●																
	PNEG110512L-PR	7.5	15.875	5.56	4.64	1.6	7.5	○			○																

### Cutting Data / Schnittdaten

Workpiece material Werkstück Material	Hardness HB Härte	Grade Sorte	Cutting data / Schnittdaten												
			V <sub>c</sub> (m/min)	f <sub>z</sub> (mm/z)			a <sub>p,max</sub> (mm)								
				PF	PM	PR									
<b>P</b> Low-carbon steel Soft steel Niedriglegierter Kohlenstoffstahl Baustahl	≤180	YBM253 YBC302	270 (220-350)	0.15 (0.1-0.2)	0.2 (0.1-0.3)	0.3 (0.2-0.4)	7.5								
								High-carbon steel Alloy steel Hochleg. Kohlenstoffstahl	180-280	YBM253 YBC302	260 (200-320)	0.15 (0.1-0.2)	0.2 (0.1-0.3)	0.3 (0.2-0.4)	7.5
<b>K</b> Cast iron Gusseisen	180-250	YBD152	270 (150-300)	CF	CM	CR	5								
				0.15 (0.1-0.2)	0.2 (0.1-0.3)	0.3 (0.2-0.4)									

# EMP13 $Kr=90^\circ$

Achieving  $90^\circ$  with high quality Square Shoulder Milling Tools

Erreichen Sie  $90^\circ$  mit der neuen Eckfräuserserie

Double negative rake angle of the tool body in combination with extra thick insert achieves double positive tool angle, which will help reduce cutting resistance and greatly improve impact resistance.

Durch den doppelt negativen Spanwinkel des Körpers in Kombination mit extra dicken Wendeschneidplatten wird ein doppelt positiver Werkwinkel erzeugt, der den Schneidwiderstand reduziert und gleichzeitig die Stoßfestigkeit stark verbessert.

Maximum cutting depth:  
Maximale Schnitttiefe:

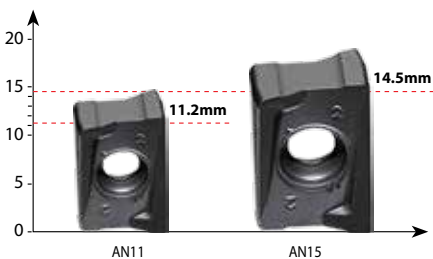

## Example

### Beispiel

Workpiece Material: Mold Steel(HRC36)

Werkstück Material: Gesenkstahl(HRC36)

Tool / Werkzeug: EMP13-032-G32-AN15-02

Inserts / WSP: ANG150608PNR-GM/YBG205

cutting data:  $V_c=220\text{m/min}$ ,  $f_z=0.1\text{mm/z}$ ,  
Schnittdaten:  $ap=14.5\text{mm}$ ,  $ae=10\text{mm}$

Cutting condition: Dry cutting  
Schnittbedingungen: Trocken

Comparison of Surface Quality:  
Vergleich der Oberflächengüte:

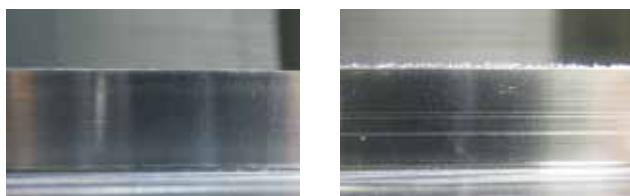

EMP13

Wettbewerber A

Specially designed cutting edge with high precision control can achieve high quality  $90^\circ$  square shoulder milling.

Speziell entwickelte Schneidkanten mit hoher Präzisionskontrolle für qualitativ hochwertiges  $90^\circ$  Eckfräser.

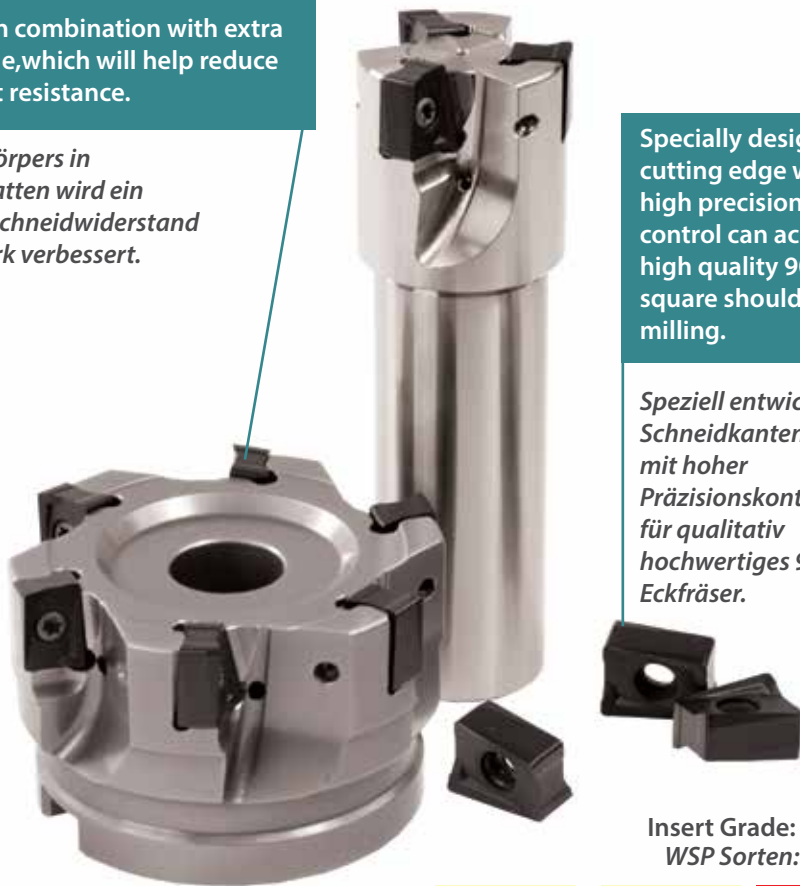

Insert Grade:  
WSP Sorten:

**YBM253**

CVD  
P20 - P40  
M10 - M30

**YBG205**

PVD  
P10 - P30  
M20 - M30

**YBD152**

CVD  
K05-K25

The component machined by using EMP13 shows better surface quality and verticality than the similar products from company A.

Das Werkstück, das mit EMP13 bearbeitet wurde, weist eine bessere Oberflächengüte und – Vertikalität auf als nach der Bearbeitung mit einem ähnlichen Produkt vom Wettbewerber. 15

### Square Shoulder Milling Tools · Eckfräser

Kr:90°



**EMP13 P K**

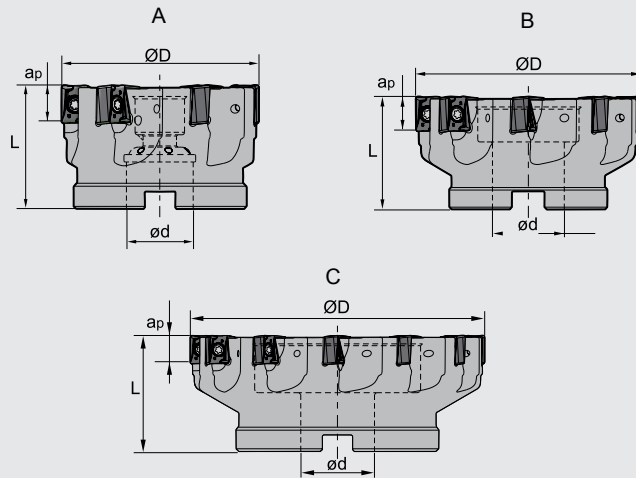

#### Specification of tools · Werkzeug Beschreibung

Type Typ	*	Stock Lager		Dimension (mm) Abmessung				No. of teeth Zähne	Coupling Aufnahme	Weight Gewicht (kg)	
		R	L	ØD	Ød	L	a <sub>pmax</sub>				
<b>EMP13</b>	-050-A22-AN11-06	*	●		50	22	40	11.2	6	A	0.30
	-063-A22-AN11-07	*	●		63	22	40	11.2	7	A	0.49
	-080-A27-AN11-09	*	●		80	27	50	11.2	9	A	1.18
	-100-B32-AN11-12		●		100	32	50	11.2	12	B	1.46
	-100-B32-AN11-12C	*	○		100	32	50	11.2	12	B	1.46
	-125-B40-AN11-14		●		125	40	63	11.2	14	B	2.92
	-125-B40-AN11-14C	*	○		125	40	63	11.2	14	B	2.92
	-160-C40-AN11-16		●		160	40	63	11.2	16	C	4.30
<b>EMP13</b>	-050-A22-AN15-04	*	●		50	22	40	14.5	4	A	0.26
	-063-A22-AN15-05	*	●		63	22	40	14.5	5	A	0.53
	-080-A27-AN15-06	*	●		80	27	50	14.5	6	A	1.23
	-100-B32-AN15-08		○		100	32	50	14.5	8	B	1.52
	-100-B32-AN15-08C	*	○		100	32	50	14.5	8	B	1.52
	-125-B40-AN15-10		●		125	40	63	14.5	10	B	3.05
	-125-B40-AN15-10C	*	○		125	40	63	14.5	10	B	3.05
	-160-C40-AN15-12		●		160	40	63	14.5	12	C	4.46

\* Internal coolant · Innenkühlung

● Ex stock / ab Lager ○ On demand / auf Anfrage

#### Spare Parts · Ersatzteile

Diameter Durchmesser Ø D	Insert WSP	Screw Schraube	Drehmoment Torque	Wrench Schlüssel	
Ø50-Ø160	ANGX110504PNR-GM	I60M3X9	2 Nm	WT09IS	
	ANGX110508PNR-GM				
Ø50-Ø160	ANGX150608PNR-GM	I60M4X12	3 Nm	WT15IS	
	ANGX150616PNR-GM				



### Square Shoulder Milling Tools · Eckfräser

Kr:90°

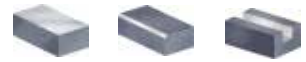

#### EMP13 P K

Weldon shank  
Weldon-Schaft



Straight shank  
Zylinder-Schaft

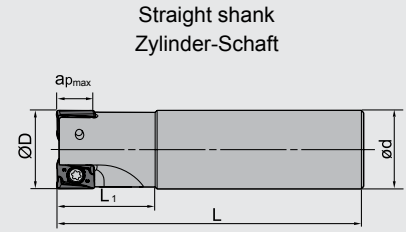
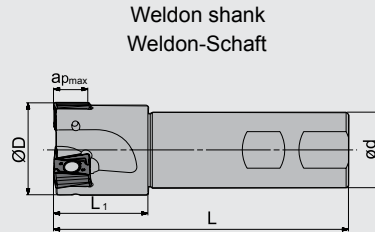

#### Specification of tools · Werkzeug Beschreibung

Type Typ	* *	Stock Lager		Dimension (mm) Abmessung					No. of teeth Zähne	Weight Gewicht (kg)	
		R	L	ØD	Ød	L	L <sub>1</sub>	a <sub>p,max</sub>			
Weldon shank Weldon-Schaft	EMP13 -025-XP25-AN11-02	*	●		25	25	100	32	11.2	2	0.31
	-032-XP32-AN11-03	*	●		32	32	115	40	11.2	3	0.61
	-040-XP32-AN11-04	*	●		40	32	125	40	11.2	4	0.75
	-032-XP32-AN15-02	*	●		32	32	125	40	11.2	2	0.66
	-040-XP32-AN15-03	*	●		40	32	125	40	11.2	3	0.76
Straight shank Zylinder-Schaft	EMP13 -025-G25-AN11-02	*	●		25	25	100	32	11.2	2	0.31
	-032-G32-AN11-03	*	●		32	32	115	40	11.2	3	0.61
	-040-G32-AN11-04	*	●		40	32	125	40	11.2	4	0.75
	-032-G32-AN15-02	*	●		32	32	125	40	14.5	2	0.66
	-040-G32-AN15-03	*	●		40	32	125	40	14.5	3	0.76

\* Internal coolant · Innenkühlung

● Ex stock / ab Lager ○ On demand / auf Anfrage

#### Spare Parts · Ersatzteile

Diameter Durchmesser Ø D	Insert WSP	Screw Schraube	Drehmoment Torque	Wrench Schlüssel	
Ø25-Ø40	ANGX110504PNR-GM	I60M3X9	2 Nm	WT09IS	
	ANGX110508PNR-GM				
Ø32-Ø40	ANGX150608PNR-GM	I60M4X12	3 Nm	WT15IS	
	ANGX150616PNR-GM				

We recommend to use torque wrenches · Wir empfehlen den Einsatz von Drehmomentschlüsseln

### Square Shoulder Milling Tools · Eckfräser

Kr:90°



**EMP13** P K

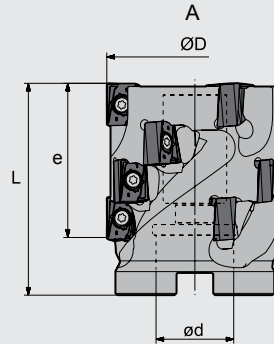



#### ■ Specification of tools · Werkzeug Beschreibung

Type Typ	Stock Lager		Dimension (mm) Abmessung				No. of flutes Zähne	No. of inserts	Mounting style	Weight Gewicht (kg)	
	R	L	ØD	Ød	L	e					
<b>EMP13</b>	-050X43-A22-AN11-03	○		50	22	60	43	3	12	A	0.52
	-063X65-A27-AN11-04	○		63	27	80	64	4	24	A	1.15
	-063X53-A27-AN15-03	○		63	27	75	53	3	12	A	1.14
	-080X56-A32-AN15-04	○		80	32	75	53	4	16	A	1.82

● Ex stock / ab Lager ○ On demand / auf Anfrage

#### ■ Spare Parts · Ersatzteile

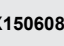
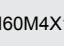
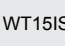
Diameter Durchmesser Ø D	Insert WSP	Screw Schraube	Drehmoment Torque	Wrench Schlüssel
Ø50-Ø63	 <b>ANGX110504PNR-GM</b>	 I60M3X9	2 Nm	 WT09IS
Ø63-Ø80	 <b>ANGX150608PNR-GM</b>	 I60M4X12	3 Nm	 WT15IS



### Square Shoulder Milling Tools · Eckfräser

Kr:90°



**EMP13** **P** **K**

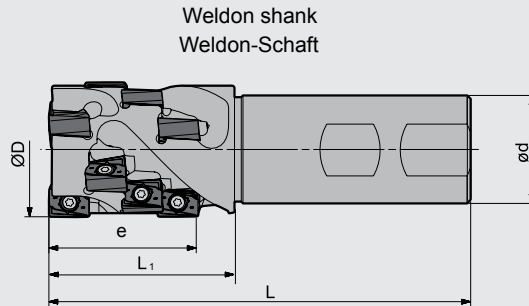





#### Specification of tools · Werkzeug Beschreibung

Type Typ	Stock Lager	Dimension (mm) Abmessung						No. of flutes Zähne	No. of inserts Aufnahme	Weight Gewicht (kg)
		R	L	ØD	Ød	L	L <sub>1</sub>			
<b>EMP13</b>	○		32	32	115	48	43	2	8	0.61
	○		40	32	125	55	43	3	12	0.79
	○		40	32	115	55	40	2	6	0.79
	○		50	40	145	70	53	2	8	1.53

● Ex stock / ab Lager ○ On demand / auf Anfrage

#### Spare Parts · Ersatzteile

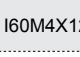
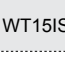
Diameter Durchmesser Ø D	Insert WSP	Screw Schraube	Drehmoment Torque	Wrench Schlüssel
Ø32-Ø40	 <b>ANGX110504PNR-GM</b>	 I60M3X9	2 Nm	 WT09IS
Ø40-Ø50	 <b>ANGX150608PNR-GM</b>	 I60M4X12	3 Nm	 WT15IS



We recommend to use torque wrenches · Wir empfehlen den Einsatz von Drehmomentschlüsseln











# ZCC-CT

Sales center in Europe  
Vertriebszentrale in Europa:

**ZCC Cutting Tools Europe GmbH**

[www.zccct-europe.com](http://www.zccct-europe.com) [www.zccct.com](http://www.zccct.com)

Heltorfer Straße 12 40472 Düsseldorf, Germany

Tel.: +49(0)211-989240-0

Fax: +49(0)211-989240-111

E-mail: [Info@zccct-europe.com](mailto:Info@zccct-europe.com)

Distributor  
Vertretung

